

TRANSMICOR T252 Series Low temperature

RELATIVE HUMIDITY TRANSMITTER DUCT VERSION



Main Features

- Measuring range: 0...100%RH, -30...+85°C
- Accuracy: $\pm 2\%$ RH, $\pm 0,2^\circ\text{C}$
- Humidity output signal:
0...1Vdc; 0...10Vdc; 0...20mA; 4...20mA; 2...10Vdc
(selectable through internal switches)
- Temperature output signal:
0...1Vdc; 0...10mA; 4...20mA; 2...10Vdc
(selectable through internal switches), Pt100 Ω 1/3DIN
- Power supply: 24Vac/dc
- Protection degree: IP65
- Interchangeable sensor module S6000
- Linearised and temperature compensated humidity measurement
- Capacity thin film humidity sensor
- Response time: < 10 seconds
- CE Conformity

The T252 series relative probe is equipped with the calibrated and fully interchangeable sensor module HUMICOR S6000, presenting an innovative element in humidity measurement. Maintenance cost is therefore drastically reduced and machine downtime is minimised.

DIMENSIONS

TECHNICAL DATA

	Humidity	Temperature
Connections	4-wire	4-wire
Accuracy @ 23°C	Hysteresis and non-linearity included $\pm 2\%$ RH (5...95% RH) $\pm 2,5\%$ RH (< 5% RH, > 95% RH)	Pt100 Ω 1/3DIN direct: $\pm 0,2^\circ\text{C}$ Current output: $\pm 0,4^\circ\text{C}$ Voltage output: $\pm 0,3^\circ\text{C}$
Measuring range	0...100% RH	-30...+85°C
Sensor response time	(90% of the range from 11% to 75% RH) < 10 sec	/
Output signal		Pt100 Ω direct 1/3DIN (3-wire)
Temperature range	/	-30...+70°C, 0...100°C
Power supply: E	9...32Vdc 15...28Vac	
Impedance: R	Current output: R < 500 Ω Voltage output: R > 1K Ω	
Power consumption	7VA	
Operating range		
Probe	0...100% RH	-30...+85°C
Housing	0...100% RH	-30...+70°C
Storage	0...100% RH	-40...+70°C
Housing		
Dimensions	98*64*38	
Material	ABS	
Weight	(DELTRIN), 1,4 Kg (INOX)	
Probe		
Dimensions	\varnothing 22mm, L = 250 o 500mm	
Material	DELTRIN o INOX	
Protection degree	IP65	
Electrical connections	Solder connector	

DELTRIN MODEL

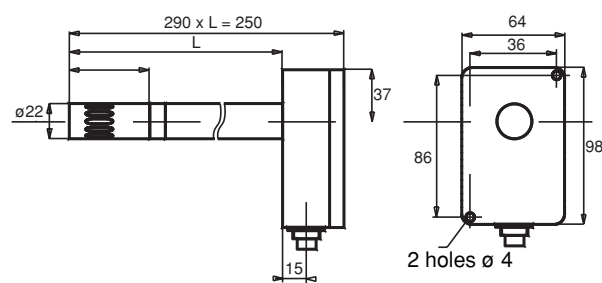

INOX MODEL

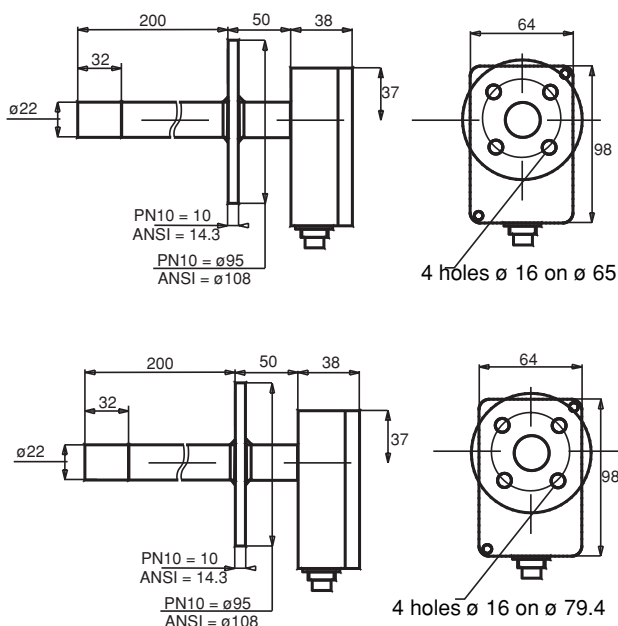

ELECTRICAL CONNECTIONS

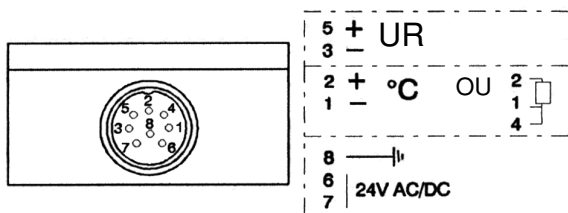

DIP-SWITCHES

Temperature Output Configuration

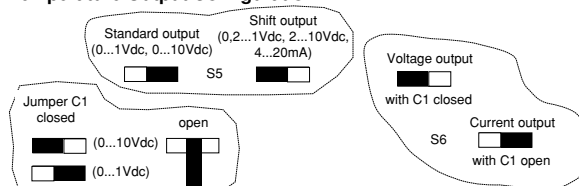

Relative Humidity Output Configuration

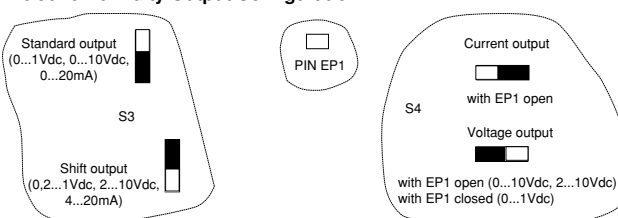

Power supply Configuration



MEASURING RANGE

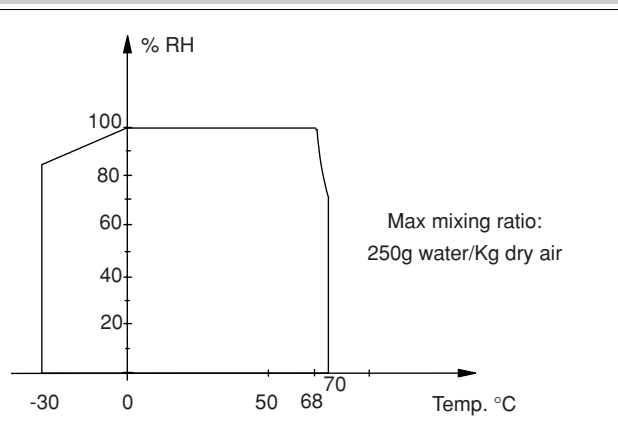

ACCESSOIRES

Control Kit HKC:

You can check your hygrometer with the control kit HKC, which is based on the principle of non-saturated salt solutions. Refer to technical data sheet 85523

Interchangeable sensor module S6000:

S6000 with output Pt100Ω: Ref. 6A03130
S6000 without output Pt100Ω: Ref. 6A08840

REMOVING S6000

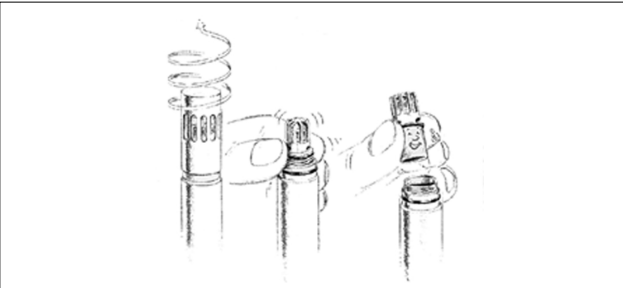

ORDER CODE

T2		5	2					
Output Signal								
0...10Vdc, 2...10Vdc, 4...20mA		5						
Model								
Duct version		2						
Temperature Range								
Without temperature		0						
Pt100 direct (Standard)		1						
Range 0...100°C		2						
Range -30...70°C		3						
Power supply (4-wire model)								
24Vac/dc		0						
Probe								
DELIN 250mm, D22mm		0						
INOX 250mm, D22mm		1						
INOX 500mm, D22mm		2						
Stainless Steel Model								
Without flange		0						
PN10 DN15 flange		1						
ASA 150 LB flange. 1 inch		2						
Protection cap / filter								
Slotted cap DELIN white (standard) with DELIN probe		A						
Slotted cap DELIN black		B						
Slotted cap DELIN white with polyethylene filter		C						
Slotted cap DELIN black with polyethylene filter		D						
Slotted cap PVDF white		E						
Slotted cap PVDF white with teflon filter		F						
Wire mesh filter, stainless steel		G						
Sinter filter, stainless steel standard with stainless steel probe		H						
Sinter filter, stainless steel, teflon coated		I						

Example: T252.310A

Relative humidity transmitter T252, duct version, with 4...20mA, 0...10Vdc, 2...10Vdc humidity (0...100%RH) and temperature (corresponding to -30...70°C) output signal, 24Vac/dc power supply, slotted cap DELIN white with DELIN probe.

GEFRAN spa reserves the right to make any kind of design or functional modification at any moment without prior notice



LEADER Electronic Co., Ltd

116, Jianghuali, Jianghua Road, Jiangmen City, GD, PRC

Tel: + 86 750 3101711, 3379183

Fax: + 86 750 3388669

Website: www.leadersensors.com

E-mail: leader@leadersensors.com



cod. 86647 - 10/01