

ISSUE 1
1/8/92 HA

ISSUE 2
TEMECULA
WAS CARSON.
ADDED SAFETY.
SEC WAS 600?
01/10/96 TS

ISSUE 3
UPDATED LABEL
REVISED DIM
20.3(0.80)MAX
WAS
19.8(0.781)MAX
02/07/96 TS

Tel: (973) 779-8282
Fax: (973) 779-1490
sales@trcelectronics.com
http://www.trcelectronics.com

TRCELECTRONICS, INC.
"Authorized Distributor"
135 Pasadena Ave.
Lodi, NJ 07644 USA

TOLERANCES (mm)	
≤ 4	± 0.2
4 ≤ 20	± 0.3
20 ≤ 50	± 0.4

PREPARED BY:

K. Brennan

ENGINEER:

T. Shiozawa

QUALITY CONTROL:

V. Casey

APPROVED:

V. Casey

TELECOMMUNICATION DRY COUPLING TRANSFORMER DESIGNED TO OPERATE AT A MAXIMUM LEVEL OF +7dBm AND TO REFLECT A PRIMARY SOURCE IMPEDANCE OF 600 Ω WITH 900 Ω LOAD ON SECONDARY

A. Electrical Specifications (@ 25 ° C)

1. Pri Source Impedance; 600Ω
2. Sec Load Impedance; 900Ω
3. Operating Level; -45 dBm to +7 dBm
4. Insertion Loss;
1.5 dB MAX @ 1 KHz, 0 dBm
5. Frequency Response (relative to 1 KHz);
±0.5 dB @ 300 Hz to 3.5 KHz, 0 dBm
6. Pri Impedance; 600 Ω ±10% @ 300 Hz to 3.5 KHz, 0 dBm
7. Return Loss; 22 dB MIN (ERL measurement)
26 dB TYP
8. Longitudinal Balance; 60 dB MIN @ 200 Hz to 4 KHz
9. DC Resistance;
(1-3) = 46 Ω ±20%
(4-6) = 100 Ω ±20%
10. Turns Ratio; (1-3) : (4-6) = 1 : 1.293 ±2%
11. Dielectric Strength;
1500 Vrms, 1 minute @ Pri to Sec, Pri to Core
1000 Vrms, 1 minute @ Sec to Core



UL# E142035

MODEL NUMBER

TTC-04

B. Marking; TTC-04, TAMURA TEMECULA, date code and country of origin

C. Safety; CSA-C22.2 No. 66-M1988 File No. LR81383
UL 1863 File No. E142035

D. Schematic Diagram

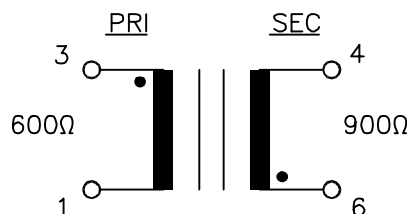

Red Dot (PIN 1)

Safety logos

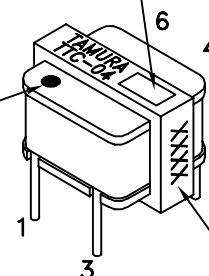

Date code and country of origin

E. Mechanical Specifications

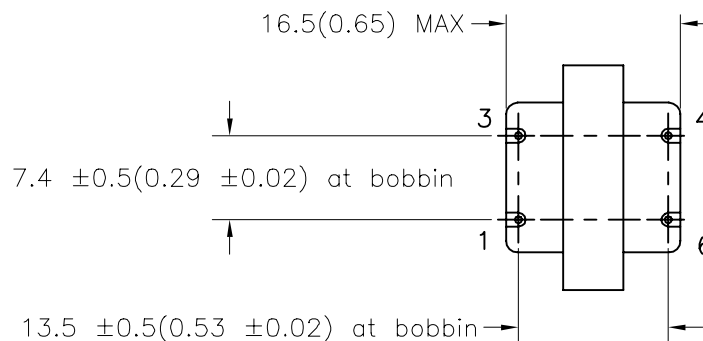
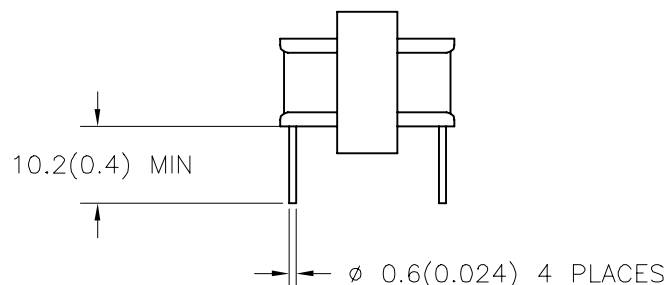
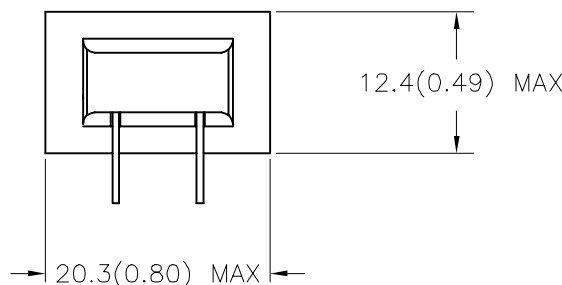

ENGINEER:	DWG CONTROL NO.	REV
T. Shiozawa	P-A1-10520	B
QUALITY CONTROL:	ACAD\TTC\A1105201.DWG	
V. Casey	CONTENTS OF THIS DRAWING ARE SUBJECT TO CHANGE WITHOUT PRIOR NOTICE	

TELECOMMUNICATION COUPLING TRANSFORMER
TAMURA CORPORATION OF AMERICA

TTC-04

MODEL SPECIFICATION

DIM: mm(in) SCL: NONE SH: 1 OF 1

PROPRIETARY NOTICE: THIS DRAWING PRINT OR DOCUMENT AND SUBJECT MATTER DISCLOSED HEREIN ARE PROPRIETARY ITEMS TO WHICH TAMURA RETAINS THE EXCLUSIVE RIGHT OF DISSEMINATION, REPRODUCTION, MANUFACTURE AND SALE. THIS DRAWING, PRINT OR DOCUMENT IS SUBMITTED IN CONFIDENCE FOR CONSIDERATION BY THE RECIPIENT ALONE UNLESS PERMISSION FOR FURTHER DISCLOSURE IS EXPRESSLY GRANTED IN WRITING.