

TELECOMMUNICATION WET COUPLING TRANSFORMER DESIGNED TO OPERATE FROM  
-45dBm TO +10dBm WITH 0 TO 90mADC IN PRIMARY AND REFLECT A PRIMARY  
SOURCE IMPEDANCE OF APPROXIMATELY 600  $\Omega$  WITH 600  $\Omega$  LOAD ON SECONDARY:

## A. Electrical Specifications (@ 25 ° C)

1. Pri Source Impedance; 600  $\Omega$
2. Sec Load Impedance; 600  $\Omega$
3. Pri DC Unbalance Current; 90mA (1-2)
4. Operating Level; -45 dBm to +10 dBm
5. Insertion Loss;  
2.0 dB MAX @ 1.8 KHz 0 dBm and DC90mA
6. Frequency Response (relative to 1.8 KHz)  
+0.2dB, -1.7dB @ 500 to 3,500 Hz 0 dBm and DC90mA  
+0.2dB, -3.5dB @ 300 to 3,500 Hz 0 dBm and DC90mA
7. Pri Impedance; 600  $\Omega$   $\pm$ 10%, -35% @ 500 to 1,800 Hz 0 dBm and DC90mA
8. Pri Return Loss; 14 dB MIN @ 1.8 KHz 0 dBm and DC90mA
9. Longitudinal Balance; 60 dB MIN @ 200 to 4,000 Hz
10. Total Harmonic Distortion; 1.0% MAX @ 300 to 3,500 Hz 0 dBm and DC80mA
11. DC Resistance;  
(1-2) = 71  $\Omega$   $\pm$ 20%  
(3-4) = 120  $\Omega$   $\pm$ 20%
12. Turns Ratio; (1-2) : (4-3) = 1 : 1.11  $\pm$ 2%
13. Dielectric Strength;  
3750 Vrms 1 minute @ Pri to Sec  
1500 Vrms 1 minute @ Pri to Core, Sec to Core



MODEL NUMBER

TTC-221

## B. Marking; TTC-221, TAMURA, date code and country of origin

C. Safety; CSA C22.2 No. 66-M1988 File No. LR81383  
UL 1863 File No. E142035

## D. Schematic Diagram

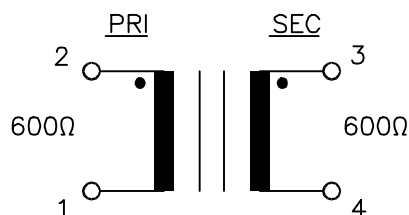

White Dot (PRIMARY)

Bevel (PIN 1)

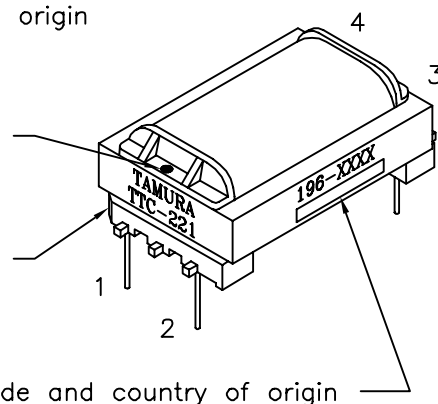

Date code and country of origin

## E. Mechanical Specifications

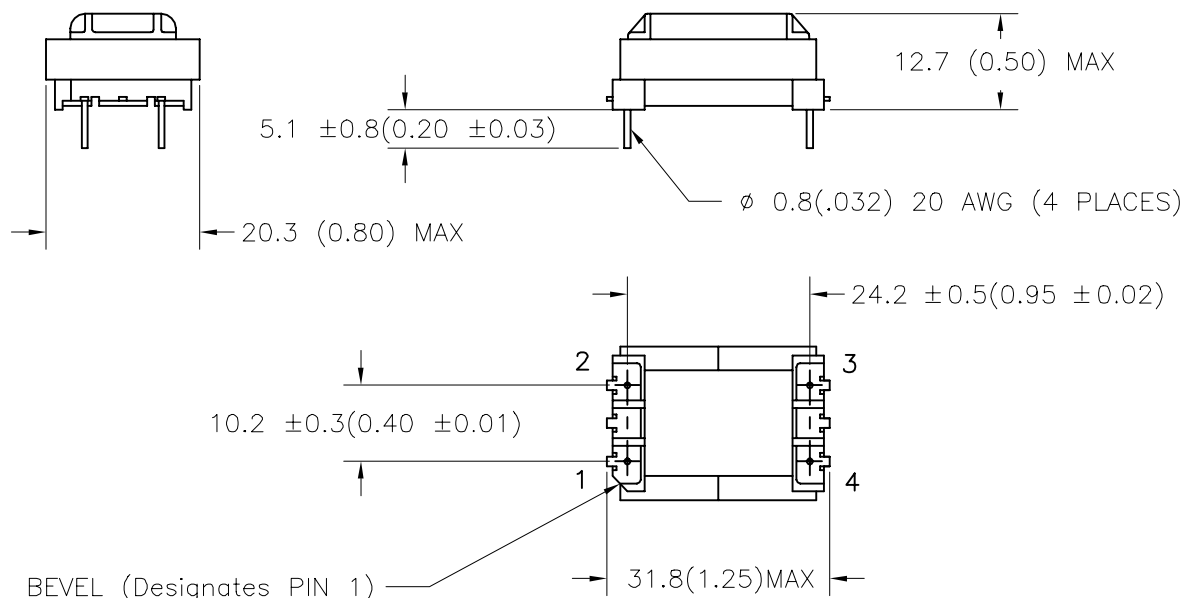

PREPARED BY:

K. Brennan

ENGINEER:

T. Shiozawa

QUALITY CONTROL:

M. Ong

APPROVED:

M. Ong

DWG CONTROL NO.

P-A1-10564

ACAD\TTC\A1105641.DWG

REV

A

TELECOMMUNICATION COUPLING  
TRANSFORMER

TAMURA CORPORATION OF AMERICA

43352 BUSINESS PARK DRIVE, TEMECULA, CA. 92590-6624

TTC-221

MODEL SPECIFICATION

DIM: mm(in) SCL: 1/1 SH: 1 OF 1

PROPRIETARY NOTICE: THIS DRAWING PRINT OR DOCUMENT AND SUBJECT MATTER DISCLOSED HEREIN ARE PROPRIETARY ITEMS TO WHICH TAMURA  
RETAINS THE EXCLUSIVE RIGHT OF DISSEMINATION, REPRODUCTION, MANUFACTURE AND SALE. THIS DRAWING, PRINT OR DOCUMENT IS SUBMITTED IN  
CONFIDENCE FOR CONSIDERATION BY THE RECIPIENT ALONE UNLESS PERMISSION FOR FURTHER DISCLOSURE IS EXPRESSLY GRANTED IN WRITING.

**TRCELECTRONICS, INC.**  
"Authorized Distributor"  
135 Pasadena Ave.  
Lodi, NJ 07644 USA

Tel: (973) 779-8282  
Fax: (973) 779-1490  
sales@trcelectronics.com  
http://www.trcelectronics.com