

STRIPLINE FLANGE TERMINATIONS

DC-26.5 GHz

SERIES PFT

GENERAL INFORMATION:

Flange terminations are used to terminate transmission lines and may be mounted in place of standard 4 hole connector patterns. VSWR is optimized & matched into $\frac{1}{8}$ inch ground plane spacing. Both potted and teflon insulated versions are available as noted.

GENERAL SPECIFICATIONS:

Temperature Coefficient:	<150 PPM/°C		
Life Test:	<1% change for 1000 hours full load and 100°C		
Moisture Resistance:	<1% change when tested per Method 106 of MIL-STD-202		
Contacts:	Copper or Brass, Gold Plated per MIL-G-45204		
Housings:	Copper or Brass, Nickel Plated per QQ-N-290 (PFT1002-1 = Aluminum Alloy with Chromate finish.)		
Resistive Element:	Proprietary thin film		
Potting:	Proprietary dielectric or teflon		
*VSWR (Max.):	DC-4 GHz	1.10	
	4-8 GHz	1.20	
	8-18 GHz	1.30	
	18-26.5 GHz	1.50	
	*as measured in a 0.125" ground plane stripline circuit.		

NOTES:

1. Power rating is with case temperature at 100°C max.
2. All models meet the applicable portions of MIL-D-39030.
3. Models to 25 Watts available on special order. Contact factory for details.
4. Models with other connector flange sizes such as BNC, TNC and N also available on special order. Contact factory for details.

PERFORMANCE SPECIFICATIONS

Part Number	Frequency Range (GHz)	Input Power (Watts)	Outline	Dielectric Insulated
PFT 500-4	DC-18	1	C	Potted
PFT 500-5	DC-18	1	C	Potted
PFT 500-6	DC-18	1	C	Potted
PFT 501-4	DC-12.4	10	D	Potted
PFT 501-8	DC-12.4	10	D	Potted
PFT 500-2	DC-12.4	15	E	Potted
PFT 500-3	DC-12.4	1	F	Potted
PFT 500-7	DC-18	1	F	Potted
PFT 500-1	DC-12.4	15	G	Potted
PFT 501-12	DC-18	10	H	Teflon
PFT 526-7**	DC-26.5	1	F	Potted
PFT 1002-1	DC-4	15	J	Teflon

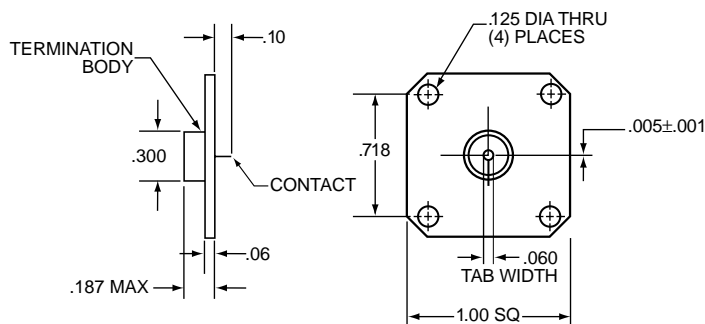

OUTLINE J

Typical VSWR Characteristics — Model PFT-500-4

STANDARD RESISTANCE: 50Ω

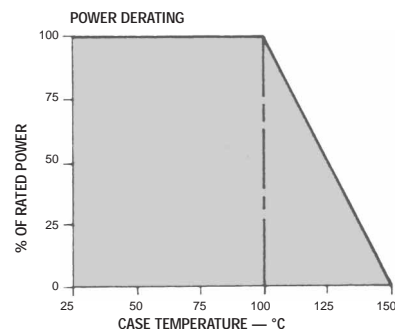
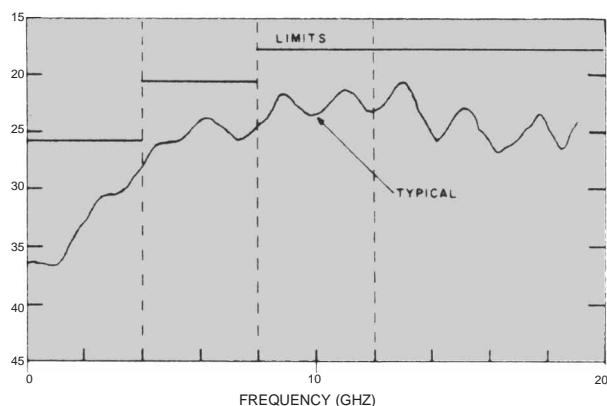

for custom products & applications contact:

KDI / TRIANGLE
CORPORATION
an MCE Company
Tel: 201-887-8100
Fax: 201-884-0445
http://kdi-triangle.com

for overnight stock shipment call:

Richardson Electronics, Ltd. 1-800-737-6937

STRIPLINE FLANGE TERMINATIONS

DC-26.5 GHz

SERIES PFT

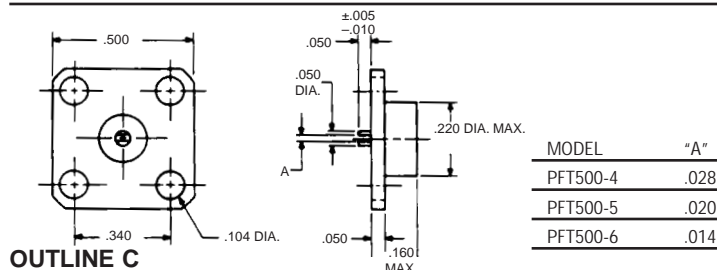

OUTLINE C

Slotted Contact Models
1 WATT

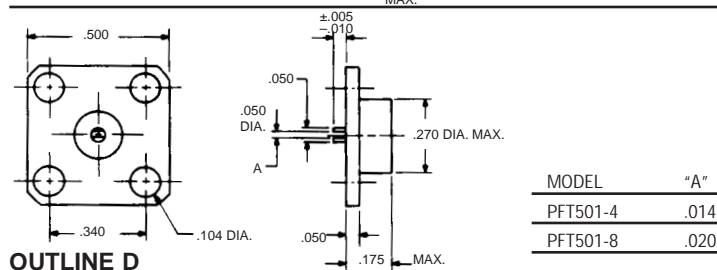
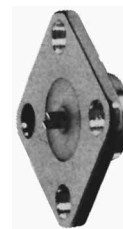

OUTLINE D

Slotted Contact Models
10 WATT

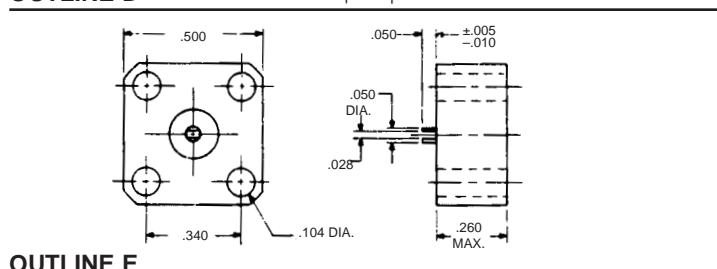
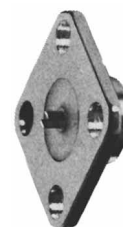

OUTLINE E

Slotted Contact Models
15 WATT

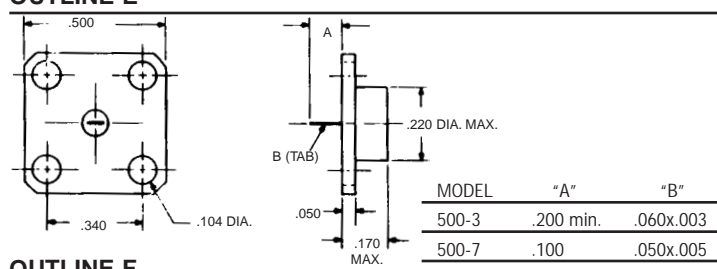
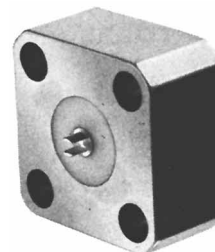

OUTLINE F

Tab Contact Models
1 WATT

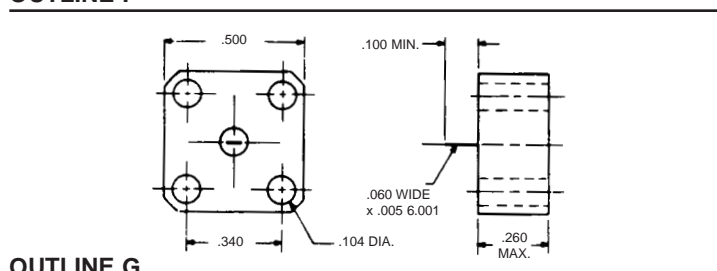

OUTLINE G

Tab Contact Models
15 WATT

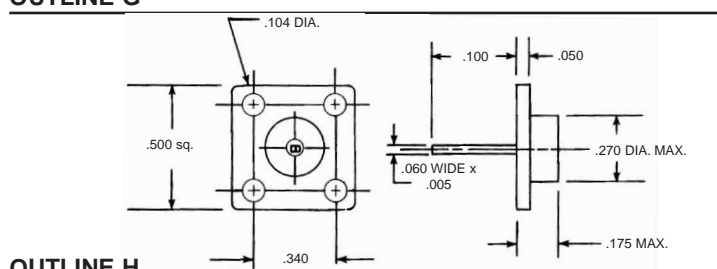
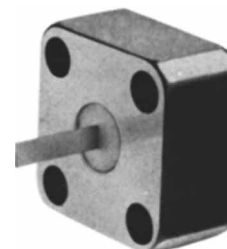

OUTLINE H

Tab Contact Models
10 WATT

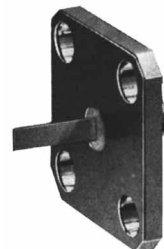

for custom products & applications contact:

KDI / TRIANGLE
CORPORATION
an MCE Company

Tel: 201-887-8100
Fax: 201-884-0445
<http://kdi-triangle.com>

for overnight stock shipment call:

Richardson
Electronics, Ltd. 1-800-737-6937