

HIGH ACCURACY AMPLIFIED VOLTAGE OUTPUT TRANSDUCER G 1/8 OR G 1/4 CONNECTIONS

PXM02 Series
0 to 5 Vdc Output
0-160 mbar to 0-400 bar

PXM02
\$630
Model Shown



- ✓ 0.15% Accuracy
- ✓ Internal Shunt Resistor for Easy System Checks
- ✓ FM Intrinsically Safe
- ✓ 5-Point Calibration Included
- ✓ All Stainless Steel Construction
- ✓ Available in Gauge, Absolute or Sealed Gauge Ranges
- ✓ Cable or Connector Models
- ✓ Optional Pressure Ports to Fit Most Industrial Applications

OMEGA's PXM02 Series transducer is a very high accuracy, amplified voltage output, industrial pressure transducer. Its all stainless steel construction and hermetically sealed case make it suitable for harsh industrial environments. FM intrinsically safe rating is standard. A broad temperature compensated range of 16 to 71°C and excellent temperature compensation make this transducer very stable with fluctuating temperatures.

The PXM02 is available in gauge, absolute or sealed models. G 1/8 and G 1/4 fittings are available for industrial and hydraulic applications.

Cable Model
PXM02MD0-10BARG5T
Shown Smaller than Actual Size



micro DIN Connector Model
PXM02MC6-10BARG5T
Shown Smaller than Actual Size

MOST POPULAR MODELS HIGHLIGHTED

To Order (Specify Model Number)

Models with G 1/4 Female Pressure Connection, Cable or Connector & 5V Output

RANGE (Bar)	MODEL NUMBER	PRICE	COMPATIBLE METERS**
Gauge Pressure			
0 to 0.16	PXM02MD[*]-160mBARG5T	\$695	DP41-E, DP25B-E
0 to 0.4	PXM02MD[*]-400mBARG5T	695	DP41-E, DP25B-E
0 to 1	PXM02MD[*]-001BARG5T	695	DP41-E, DP25B-E
0 to 1.6	PXM02MD[*]-1.60BARG5T	630	DP41-E, DP25B-E
0 to 2.5	PXM02MD[*]-2.50BARG5T	630	DP41-E, DP25B-E
0 to 4	PXM02MD[*]-004BARG5T	630	DP41-E, DP25B-E
0 to 6	PXM02MD[*]-006BARG5T	630	DP41-E, DP25B-E
0 to 10	PXM02MD[*]-010BARG5T	630	DP41-E, DP25B-E
0 to 16	PXM02MD[*]-016BARG5T	630	DP41-E, DP25B-E
0 to 25	PXM02MD[*]-025BARG5T	630	DP41-E, DP25B-E
0 to 40	PXM02MD[*]-040BARG5T	630	DP41-E, DP25B-E
0 to 60	PXM02MD[*]-060BARG5T	630	DP41-E, DP25B-E
0 to 100	PXM02MD[*]-100BARG5T	630	DP41-E, DP25B-E
0 to 160	PXM02MD[*]-160BARG5T	630	DP41-E, DP25B-E
0 to 250	PXM02MD[*]-250BARG5T	630	DP41-E, DP25B-E
0 to 400	PXM02MD[*]-400BARG5T	630	DP41-E, DP25B-E

[*] = insert "0" for 3 m Cable or "6" for micro DIN connector

**See Section D for compatible Meters

To order Absolute Pressure replace the "G" in model number with "A" (\$50 additional).
To order Sealed Gauge units replace "G" in model number with "S" (no charge).

Ordering Examples:

- 1.) PXM02MD6-004BARG5T is a 4 bar gauge transducer with 0-5 V output, micro DIN connector and G 1/4 female pressure connection, \$630. Mating Connector included.
- 2.) PXM02MD0-001BARA5T is a 1 bar absolute transducer with 0-5 V output, 3 m Cable and a G 1/4 female pressure connection, \$695 + 50 = \$745.

HIGH ACCURACY AMPLIFIED VOLTAGE OUTPUT ALL STAINLESS STEEL TRANSDUCER

SPECIFICATIONS: 0-5 Vdc OUTPUT

Excitation: 24 - 32 Vdc
Output: 0 to 5 Vdc $\pm 10\%$ adj
Linearity: 0.15% FSO
Hysteresis: 0.05% FSO
Repeatability: $\pm 0.05\%$ FSO
Zero Balance: 0 V $\pm 10\%$ adj

Agency Approvals:
 Standard FM Intrinsically Safe
 IS/I.II.III/1/CDEFG

Sensing Element:
 4 active-arm bridge, using thick
 film strain gauges in a hermetically
 sealed chamber

Shunt Calibration Value:
 Specified on Calibration sheet

Operational Temp Range:
 -46 to 121°C (-50 to 250°F)

Compensated Temp Range:
 16 to 71°C (60 to 160°F)

Thermal Effects:
Span: 0.0054% of Rdg/°C
Zero: 0.0054% of FSO/°C

Proof Pressure:
 150% of rated pressure

Burst Pressure:
 300% of rated pressure

Wetted Parts: 17-4PH Stainless Steel

Pressure Port: G 1/4 Male Std
 Optional; G 1/4 Male,
 G 1/8 Male/Female

Electrical Connections:
 Style 0 = 3 m cable
 Style "6" = micro DIN
 See Custom Configurations

Mating Connector:
 Style 1 = PT06F-10-6S (not included)
 Style "6" = included

Weight: 170 g (6 oz)

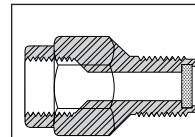

**G 1/4 Pressure
Snubbers \$10**
PSM-4 = G 1/4

Wiring Code

Pin	Connection
A:	+ OUTPUT
B:	- OUTPUT
C:	- INPUT
D:	+ INPUT
E:	SHUNT
F:	SHUNT

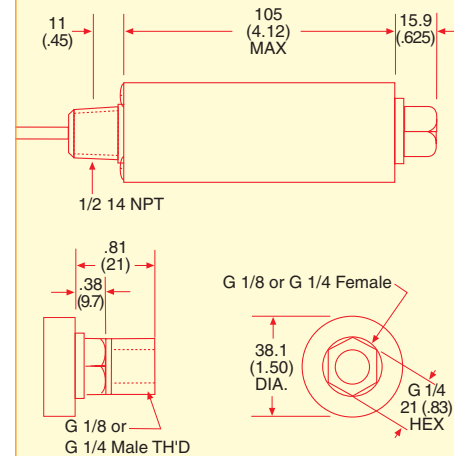

Dimensions Shown in mm (inches)

CUSTOM CONFIGURATIONS

—MODEL NUMBER SPECIFICATION:

PXM02MD0-006BARG5T

OPTION CODES (add to end of model number)

- OL (for overload stops)
- OX (cleaned for oxygen use)
- []m (Optional cable length
 Example:
 —12m = 12 metres total of cable)

OUTPUT: V = 3 mV/V nominal
 5T = 0 to 5 Vdc
 5Z = isolated to 0 to 5 Vdc
 10T = 0 to 10 Vdc
 I = 4 to 20 mA

UNITS (A = absolute, S = sealed gauge, G = gauge)

RANGE

ELECTRICAL CONNECTION:

- 0 = 3 m cable
- 1 = PTIH-10-6P connector or equiv.
- 5 = lightning protection amplifier box
 (4-20 mA models only)
- 6 = micro DIN Connector*
 (*no shunt)

PRESSURE PORT: MA = G 1/8 male
 MB = G 1/8 female
 MC = G 1/4 male
 MD = G 1/4 female - (std)

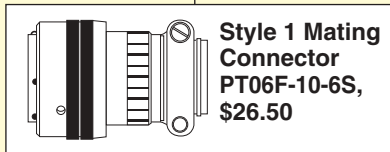

**Style 1 Mating
Connector
PT06F-10-6S,
\$26.50**

Ordering Examples:

1.) **PXM02MA6-010BARG5T** is a 10 bar Gauge Pressure transducer with a G 1/8 Male fitting, a micro DIN Connector, and 0 to 5 Vdc output, \$630. Mating Connector included.

2.) **PXM02MB0-006BARS5T** is a 6 bar Sealed Gauge Pressure transducer with a G 1/8 Female fitting, a 3 m cable, and Isolated 0 to 5 Vdc output, \$630.

3.) **PXM02MC1-001BARA5T** is a 1 bar Absolute Pressure transducer with a G 1/4 Male fitting, PTIH-10-6P Connector, and 0 to 5 Vdc output, 695 + 50 = \$745. Mating Connector (not included) order **PT06F-10-6S**, \$26.50.