

DATA SHEET

PSS1515Q-6-TO18

SILICON PHOTODIODE TYPE PSS1515Q-6-TO18

PSS1515Q-6-TO18 is a quadrant silicon photodiode with a very small active area of 0.3 mm² for each quadrant. Quadrant photodiodes find applications in electro-mechanical apparatus and are frequently used in conjunction with laser beams for alignment and target acquisition. It is mounted in a hermetically sealed glass and metal package (TO-18). The chip only is also available. Please see our PSS1515Q-6-C.

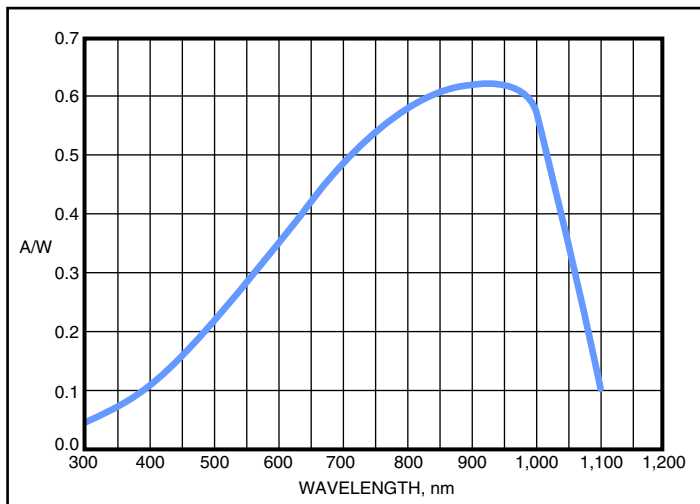

SPECTRAL RESPONSE

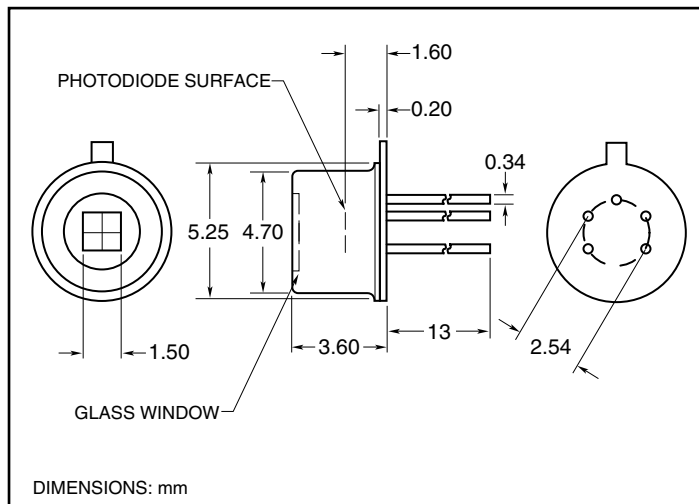

OUTLINE DIMENSIONS

PHOTODIODE CHARACTERISTICS:

PART NO.	ACTIVE AREA mm ²	ACTIVE AREA (size) mm	DARK CURRENT nA @ 1V		CAPACITANCE PF @		RISE TIME @ 663 nm μs	NEP W/H ^{1/2} OV @ 663 nm
			TYP	MAX	0V	12V		
PSS1515Q-6-TO18	0.3 x 4	0.54 x 0.54	1	5	30	10	0.1	10 ⁻¹⁴

ABSOLUTE MAXIMUM RATINGS

DC Reverse Voltage	Peak DC Current	Storage Temperature	Operating Temperature	Soldering Temperature
30 volts	10 mA	-40°C to +100°C	-25°C to 75°C	240° for 10 sec.