

Low Profile Resistance Weld Crystal

The HC49L series is a low profile AT-cut or BT-cut strip crystal housed in a low profile package meeting the standard 0.200" board spacing.

HC49L

Specifications:

Frequency Range:	3.2 MHz ~ 30 MHz Fundamental 24 MHz ~ 60 MHz Overtone
Operating Temperature:	-10°C ~ +70°C Standard -40°C ~ +85°C Extended
Storage Temperature:	-40°C ~ +85°C
Frequency Tolerance: (at 25°C)	± 100 ppm ± 50 ppm Standard ± 30 ppm ± 20 ppm ± 10 ppm
Frequency Stability: (over temperature range)	± 100 ppm ± 50 ppm Standard ± 30 ppm ± 20 ppm ± 10 ppm
Circuit Condition:	10 pF ~ 32 pF or series
Equivalent Series Resistance:	Maximum resistance corresponds to frequency. Please see ESR table.
Drive Level:	1.0 mW max
Shunt Capacitance:	7 pF max
Aging:	± 5 ppm max per year
Optional Features:	Insulator Pads Third Lead Tape & Reel

HC49L

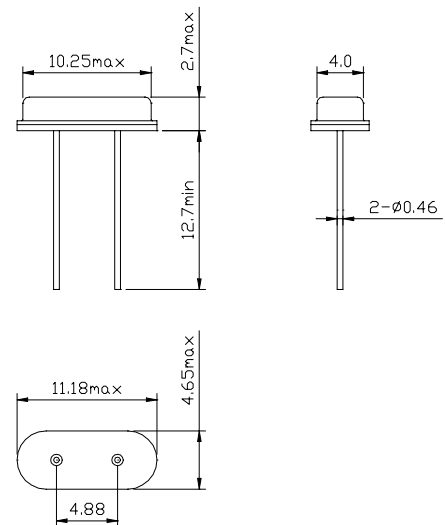

All dimensions are in mm

Ordering Information

Product name + Frequency + CL + Operating Temperature + Tolerance + Stability + Other Specification Code.

i.e. HC49L-16.00M-20-C-30-30-F

Note:

- Other frequencies, tolerances, stabilities, and operating temperature ranges available. Consult VTC Support for specific requirements.
- Not all combinations of the above tolerances, stabilities, and temperature ranges are available. Consult VTC Support if your requirement is not standard.
- All specifications subject to change without notice.