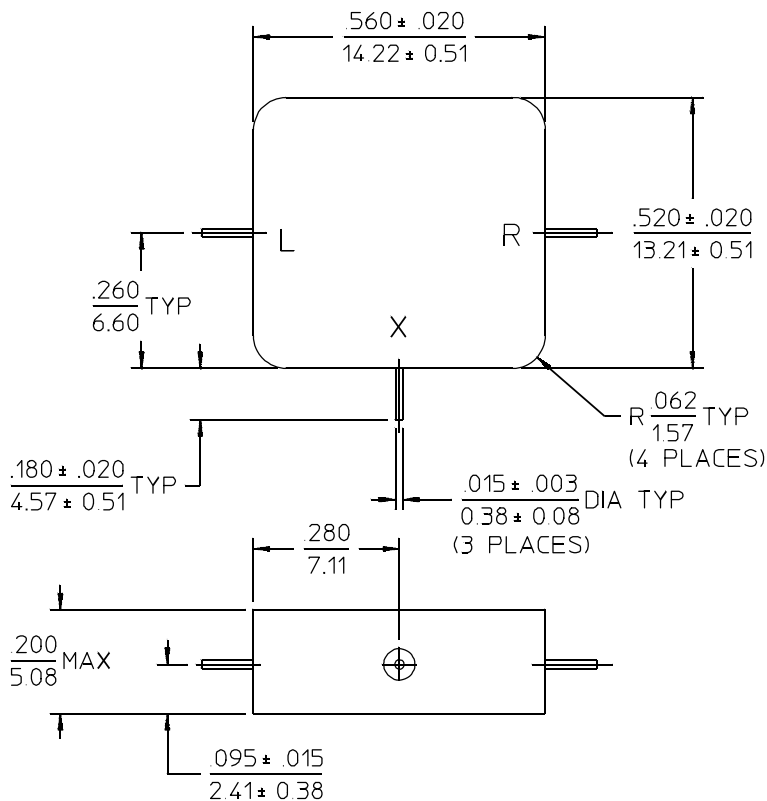

**PRINCIPAL SPECIFICATIONS**

Model Number	RF/LO Frequency, GHz	IF Frequency, Range, (-1 dB)	LO Drive, dBm, Nom.	Conversion Loss, dB,		Port Isolation, Min.			Polarity Sense
				Max.	Typ.	L-R dB	L-X dB	R-X dB	
DMF-2S-7000	4 - 18	DC - 2.5 GHz	+10	8.5	6.5	25	15	15	Negative

All specifications are as measured in a 50Ω system, at nominal LO power, in a down converter application.

**Flatpack Outline S-style**

29Apr96

**GENERAL SPECIFICATIONS**

Impedance:	50 $\Omega$ nom.
Input Intercept Point:	+13 dBm, typ. (each tone -10 dBm)
1 dB Comp. Point:	0 dBm input, typ.
CW Input Power:	300 mW @ 25°C (Derate linearly to 0 mW @ 125°C)
Weight:	0.25 oz (7 g) nom.
Operating Temperature:	-55° to +85°C

**General Notes:**

1. The DMF-2S-7000 Double Balanced Mixer covers the frequency range of 4 to 18 GHz using microwave techniques and specially selected diodes to achieve a 2.5 GHz bandwidth with other desirable high performance characteristics.
2. Merrimac offers a broad selection of Double Balanced Mixers ideal for a variety of signal processing functions with frequencies ranging from 20 kHz to 20 GHz and for applications from routine to very special.
3. Merrimac mixers comply with MIL-M-28837 and may be supplied screened for compliance with additional specifications for military and space applications requiring the highest reliability.