

## DM C146-13 GPS ANTENNA



The DM C146-13 antenna brings the proven electrical performance of the DM C146 series to high-performance, Mach II +, airframes.

The DM C146-13 antenna has been designed with broadband radiating elements and a quadrature feed network. The broadband element allows the DM C146 series to provide continuous coverage from L2 through L1 frequencies without regard for operating temperature. The quadrature feed network, beyond offering excellent circular polarization and minimum axial ratio, provides low phase ripple, excellent pattern symmetry, and a stable phase center.

The DM C146-13, offered with 2 mounting patterns, features a radome manufactured from DuPont Tefzel, a teflon based product that has been proven resistant to rain, erosion and acoustic noise damage. In addition, an aluminum bezel is incorporated into the flange to provide a secure mounting point and prevent moisture intrusion.

The DM C146-13 has been flight proven on aircraft such as the F-14, F-18, and A-10.

## SPECIFICATIONS

ELECTRICAL	Frequency Range	L1	1560 – 1590 MHz
		L2	1212 – 1242 MHz
	VSWR		2.0:1
	Gain		5 dBic at Zenith -4 dBic at 5° elevation above the horizon
	Impedance		50 Ohms
	Polarization		RHCP
	Power		Receive only
	Radiation Pattern		Omnidirectional – Azimuth Hemispherical – Vertical
MECHANICAL	Connector		TNC Female
	Weight		0.5 lbs (0.23 kg)
	Finish		Gray

Specifications subject to change without notice.

1000-100 (62)

## DM C146-13 GPS ANTENNA

### DM C146-13-1

#### OUTLINE DIMENSIONS

Inches (Centimeters)

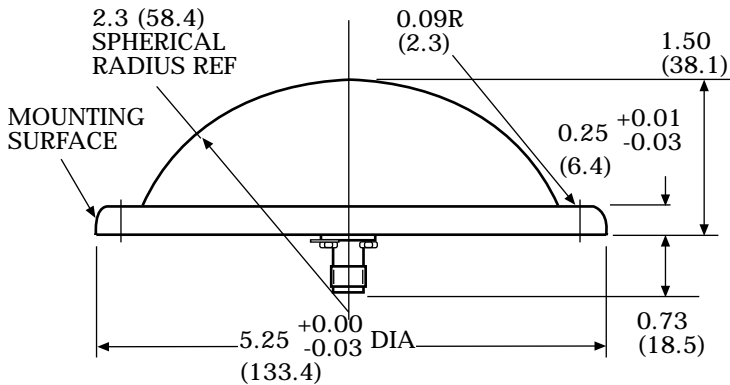

$+0.007$   
0.195  $-0.000$  DIA (4.95)  
12 HOLES EQUALLY SPACED  
ON A 4.675 BC (118.75)  
 $+0.015$   
CSK 100° x 0.390°  $-0.000$  DIA (9.91)  
FARSIDE

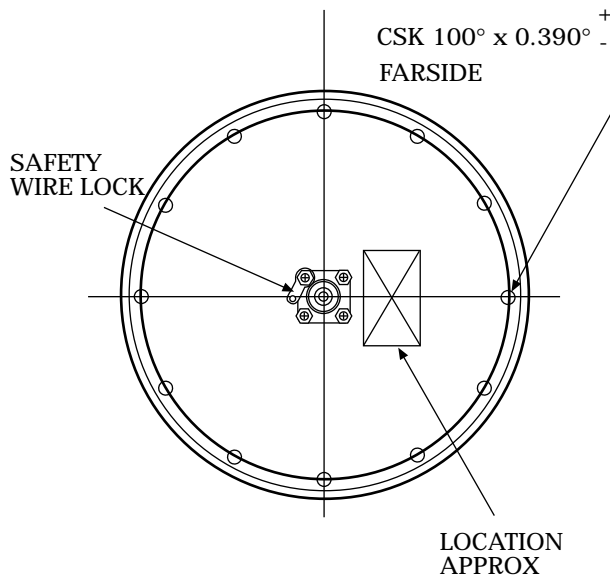

### DM C146-13-2

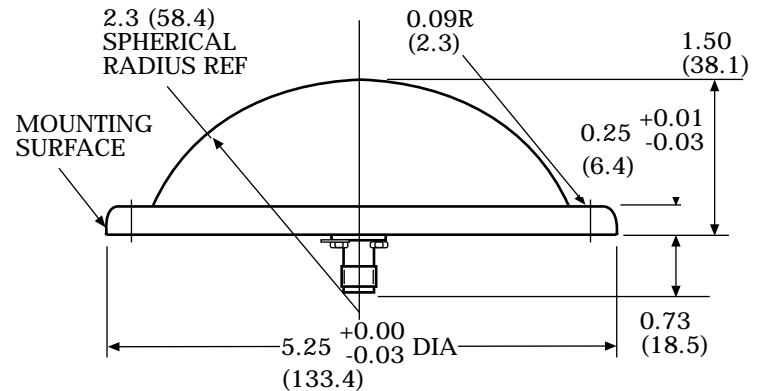

$+0.007$   
0.195  $-0.000$  DIA (4.95)  
6 HOLES EQUALLY SPACED  
ON A 4.675 BC (118.75)  
 $+0.015$   
CSK 100° x 0.390°  $-0.000$  DIA (9.91)  
FARSIDE

