

The DM N25 Series of glide slope antennas employ a grounded, center-fed loop as the radiating element. The resulting radiation patterns are symmetrical. The DM N25-2 is a dual connector version which incorporates a hybrid. This circuitry effectively isolates the two associated receiving systems providing protection against disablement of both systems in the event of failure in one system. The radiation pattern associated with each DM N25-2 antenna port is identical, so that no coupler drop-out problem during automatic landing occurs.

All DM N25 Series antennas provide complete lightning protection for the associated receivers. They are suitable for mounting either externally, or within a nose radome. The inherent 180° pattern beam may be modified slightly by the geometry surrounding the installation. The DM N25 antennas are recommended for installations in close proximity to radar dish installations since the antenna's (glide slope) sensitivity is relatively unaffected by dish motion.

It should be noted that the DM N25 antennas have mounting dimension requirements which are identical to similar function Collins and Sensor antennas. Since the mounting base-to-tip dimension of the DM N25 antenna is slightly less than the Collins and Sensor units, the DM N25 antenna is a direct replacement.

NAVIGATION

DM N25 GLIDE SLOPE ANTENNA SERIES

SPECIFICATIONS

ELECTRICAL	Frequency Range		329 – 335.3 MHz
	VSWR	DM N25-1	5:1
		DM N25-2	3:1
		DM N25-3 (AT-983)	3:1
	Gain		0 dB
Polarization		Horizontal	
Impedance		50 Ohms	
MECHANICAL	Weight	DM N25-1	(0.23 kg) 8 oz
		DM N25-2	(0.39 kg) 14 oz
		DM N25-3 (AT-983)	(0.23 kg) 8 oz
	Outline Dimensions		See back of page
	Connectors	DM N25-1	Type TNC Female
		DM N25-2	Type C Female
		DM N25-3 (AT-983)	Pressurized Type N Female
	Type of Constructions		All aluminum with dielectric sealed feed point.
	Military		Qualified for vibration, humidity, temperature-altitude shock and salt spray
	per MIL-T-5422E		
FAA		TSO C34b	

DM N25 GLIDE SLOPE ANTENNA SERIES

OUTLINE DIMENSIONS

Inches (Centimeters)

Note:
* DM N25-3 (AT-983) is identical in configuration to DM N25-1 except that DM N25-3 is provided with a pressurized type N connector and the connector height is 0.88 (2 PL).

DM N25-1 DM N25-3

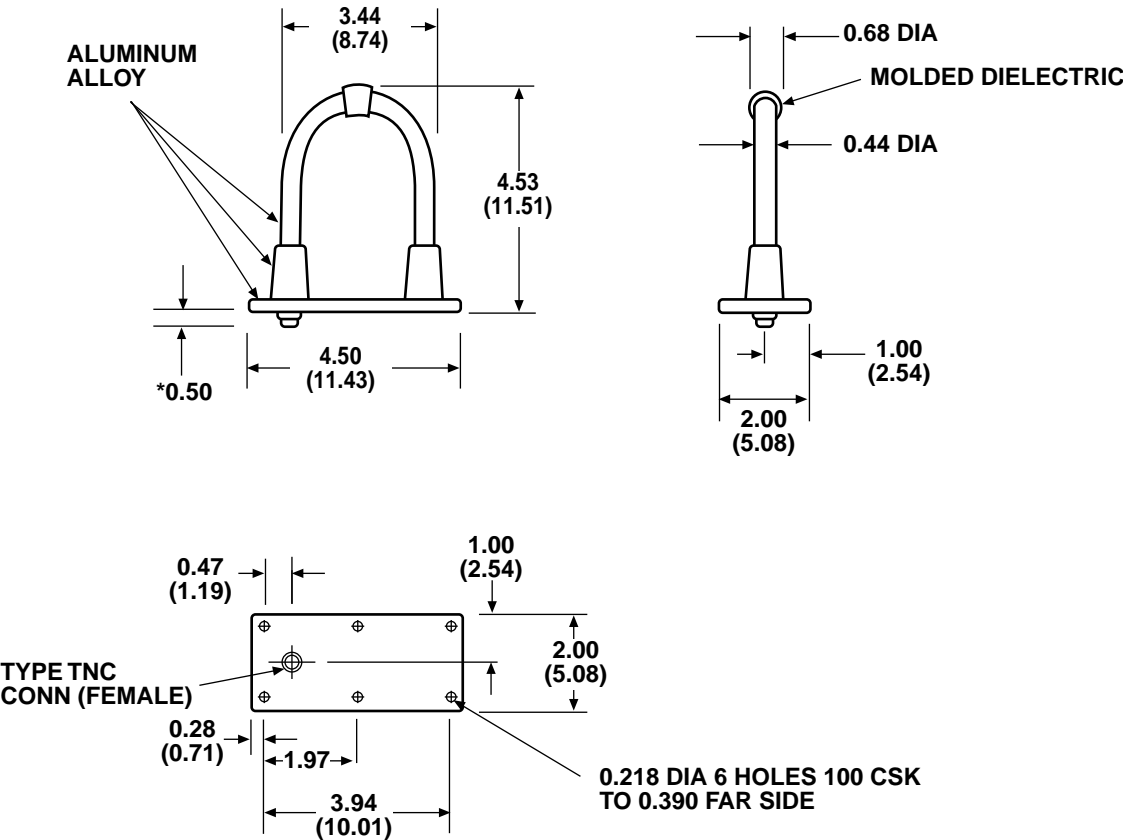

INTERCHANGEABLE WITH COLLINS 37P4

DM N25-2

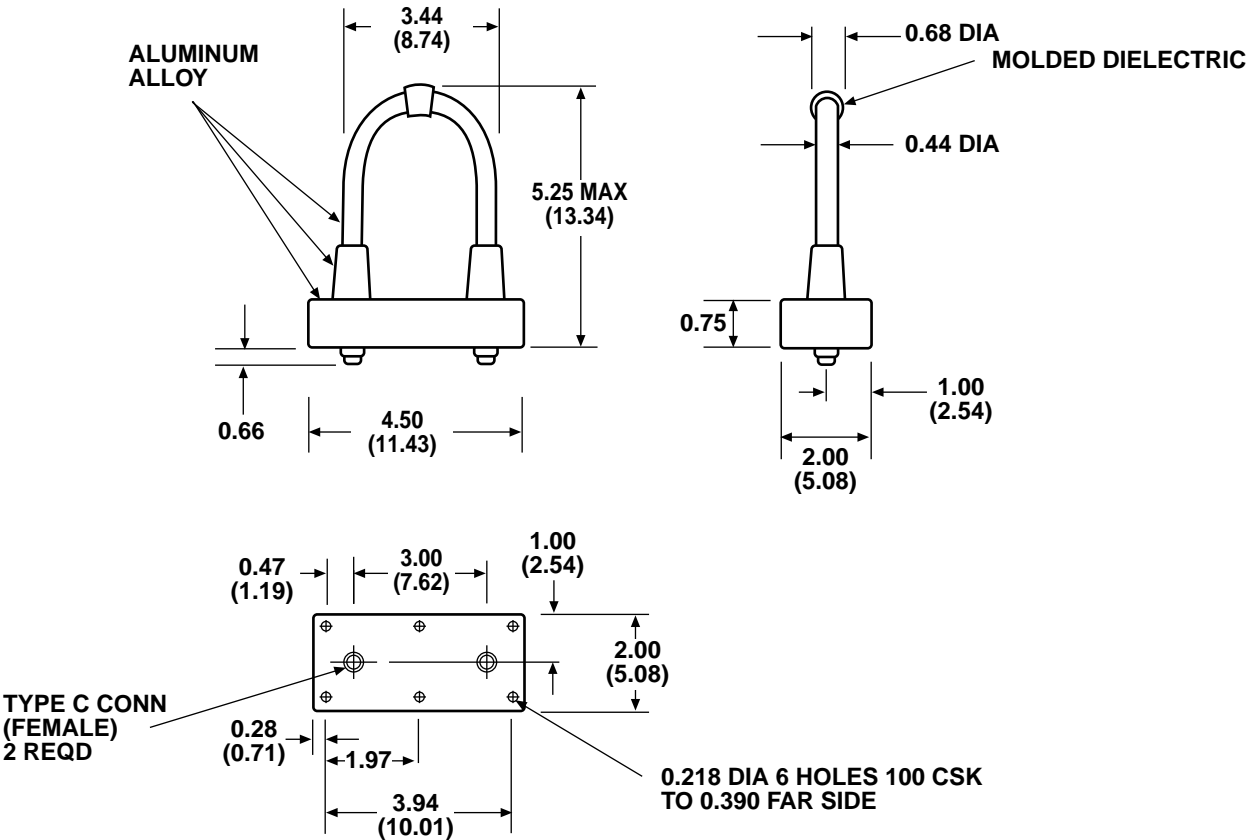

INTERCHANGEABLE WITH COLLINS 37P5 AND SENSOR S41422

If space considerations prevent use of the DM N25 Series type antenna, the DM N1-2 glide slope antenna is available. This unit attaches to the radome itself and has a height of less than 1/4 inch. Other models are also available for special applications. Consult our Engineering Department with data on your particular radome.