

DC BLOCK / ATTENUATOR

TYPE F

10 MHz - 2 GHz
200 Volts



MODELS: 8528A

SPECIFICATIONS:

Electrical:

Frequency Range _____ 10 MHz - 2 GHz
Standard dB Values* _____ 0 - 10, 12, 15 & 20 dB
Accuracy of Attenuation: _____ In 1 dB Increments
1 - 6 dB _____ ± 0.3 dB
7 - 20 dB _____ ± 0.5 dB
VSWR: _____ 1.35:1 Max.
Impedance: _____ 75 Ohms
DC Block Type _____ Inner Only
Voltage Rating _____ 200 Volts
Input Power _____ 2 Watts Average
Operating Temp. Range _____ -65°C to $+125^{\circ}\text{C}$

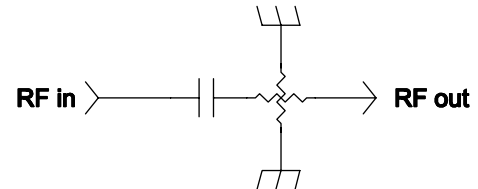

Mechanical:

Type F Connectors: _____ Bright Acid Tin and Nickel Plated Brass
Mates with IPS-SP-400 & IPS-SP-401
Conductors: _____ Nickel and Gold Plated Brass
Bodies: _____ Passivated Stainless Steel

Schematic Diagram

Model Number: **8528A-XX**
Male/Female Connectors
Length: $1.50 \pm .05$ [38.1 \pm 1.3]
As Pictured

Model Number: **8528A-XXM**
Male/Male Connectors
Length: $1.22 \pm .05$ [31.0 \pm 1.3]

Model Number: **8528A-XXF**
Female/Female Connectors
Length: $1.79 \pm .05$ [45.5 \pm 1.3]

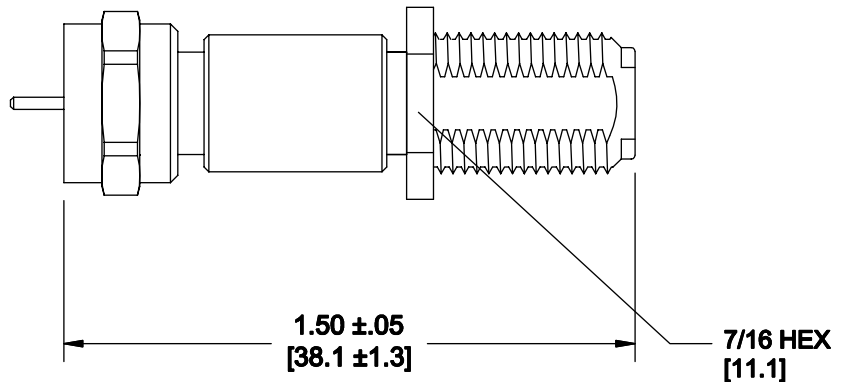

HOW TO ORDER:

Model Number: **8528A-XXY**

Connector Configuration
= Male/Female
F = Fem/Fem
M = Male/Male

dB Value

Ordering Examples:

Model Number: **8528A-20**
20 dB; F - Male/Fem

Model Number: **8528A-10M**
10 dB; F - Male/Male

Note: Dimensions in Brackets are Expressed in Millimeters and are for Reference Only.

*Other db values, connectors and/or DC Block configurations are also available.

8528A; REV B