

DC BLOCKS, Between Series

TYPE N /SMA

10 MHz - 18 GHz
Inner Only



MODELS: 8301, 8302, 8303, 8304

SPECIFICATIONS:

Electrical:

Frequency Range _____ 10 MHz - 18 GHz
VSWR _____ 1.35:1 Max.
Impedance _____ 50 Ohms
Insertion Loss _____ 0.5 dB Max.
Voltage Rating _____ 200 Volts
Operating Temp. Range _____ -65°C to +125°C

Mechanical:

Connectors _____ Passivated Stainless Steel
Mates with MIL-STD-348
Conductors _____ Gold Plated Beryllium Copper

Model Number: **8301**
Type N Male / SMA Male

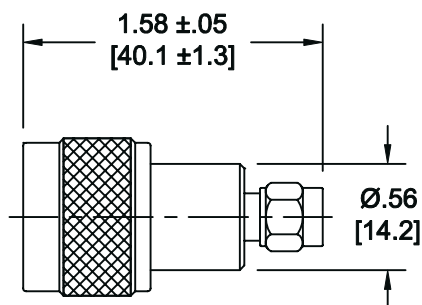

Model Number: **8302**
Type N Male / SMA Female

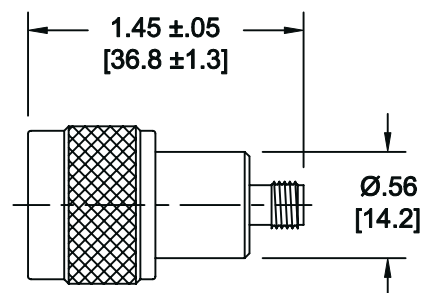

Model Number: **8303**
Type N Female / SMA Male

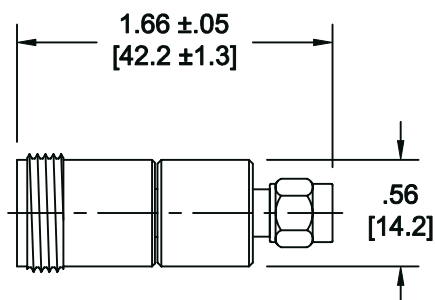

Model Number: **8304**
Type N Female / SMA Female

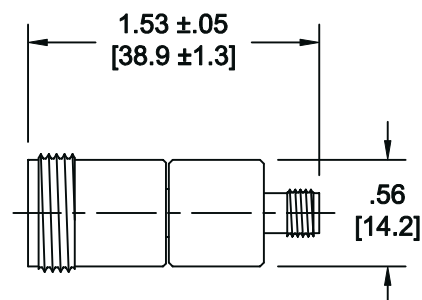

Note: Dimensions in Brackets are Expressed in Millimeters and are for Reference Only.

8301; REV B