



# EVERLIGHT ELECTRONICS CO.,LTD.

Device Number : DLE-731-008 REV: 1.0

5.2X3.8 mm Elliptical Wide Angle LEDs

PART NO : 7313-2UBD/C470/S1059 ECN :                      Page: 1/4

## ■ Features :

- Low power consumption.
- Versatile mounting PCB or panel.
- High efficiency.
- IC compatible/low current requirement.

## ■ Descriptions :

- The series is 5.2X3.8mm LED lamps.
- The series is specially designed for applications requiring higher brightness.
- The LED lamps are available with different colors,intensities, epoxy colors, etc.

## ■ Package Dimensions:

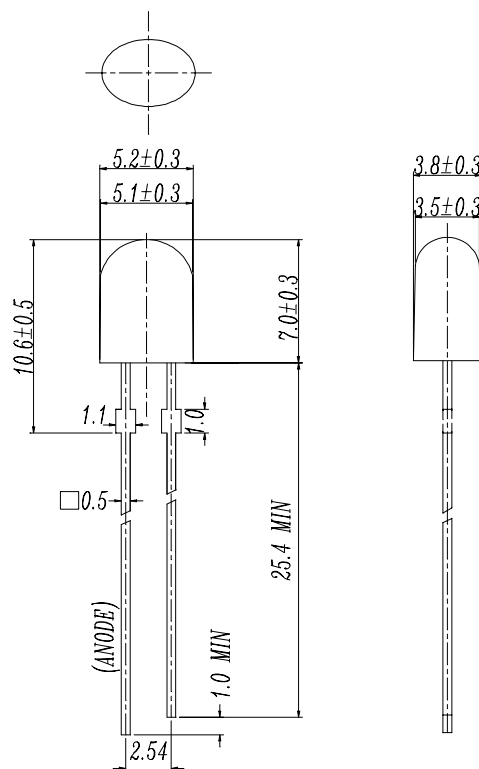

## ■ Applications :

- TV Set
- Monitor
- Telephone
- Computer

## ■ Notes :

- 1.All dimensions are in millimeters.
2. An epoxy meniscus may extend about 1.5mm(0.059") down to the lead.
- 3.Tolerances unless dimension  $\pm 0.25$ mm

PART NO	Chip		Lens Color
	Material	Emitted Color	
7313-2UBD/C470/S1059	InGaN/SiC	Blue	Blue Diffused

B90010314,9002011

OFFICE : NO. 25,Lane 76,Sec.3, Chung Yang Rd., Tucheng 236, Taipei, Taiwan, R.O.C.

TEL : 886-2-2267-2000,2267-9936

FAX : 886-2-2267-6244,22676189,22676306

<http://www.everlight.com>



# EVERLIGHT ELECTRONICS CO.,LTD.

Device Number : DLE-731-008 REV: 1.0

5.2X3.8 mm Elliptical Wide Angle LEDs

PART NO : 7313-2UBD/C470/S1059 ECN :                      Page: 2/4

## ■ Absolute Maximum Ratings at Ta = 25°C

Parameter	Symbol	Rating	Unit
Forward Current	IF	30	mA
Operating Temperature	Topr	-40 to +85	°C
Storage Temperature	Tstg	-40 to +100	°C
Soldering Temperature	Tsol	260 ± 5	°C
Electrostatic Discharge	ESD	1000	V
Power Dissipation	Pd	120	mW
Peak Forward Current(Duty 1/10 @ 1KHz)	IF(Peak)	100	mA
Reverse Voltage	VR	5	V

## ■ Electronic Optical Characteristics :

Parameter	Symbol	Min.	Typ.	Max.	Unit	Condition
Luminous Intensity	Iv	100	160	----	mcd	IF=20mA
Viewing Angle	2 θ 1/2	----	X:55 Y:25	----	deg	IF=20mA
Peak Wavelength	λ p	----	468	----	nm	IF=20mA
Dominant Wavelength	λ d	----	470	----	nm	IF=20mA
Spectrum Radiation Bandwidth	△ λ	----	26	----	nm	IF=20mA
Forward Voltage	VF	----	3.5	4.3	V	IF=20mA
Reverse Current	IR	----	----	50	μ A	VR=5V



EVERLIGHT ELECTRONICS CO.,LTD.

Device Number : DLE-731-008

REV: 1.0

5.2X3.8 mm Elliptical Wide Angle LEDs

PART NO : 7313-2UBD/C470/S1059

ECN :

Page: 3/4

### Typical Electro-Optical Characteristic Curves

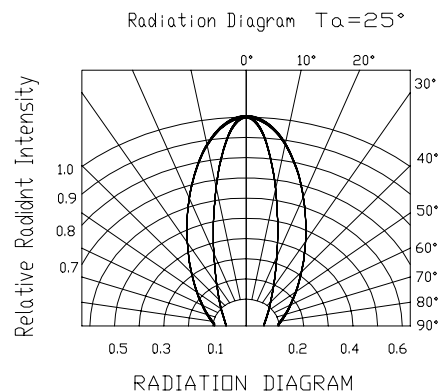
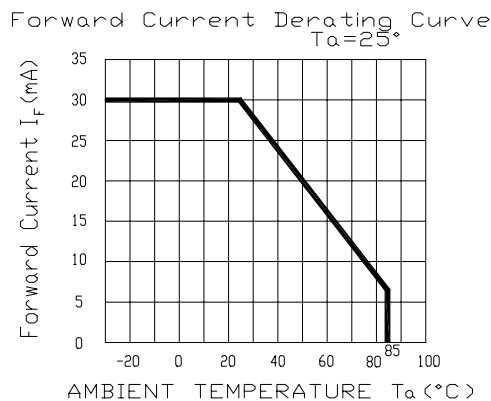
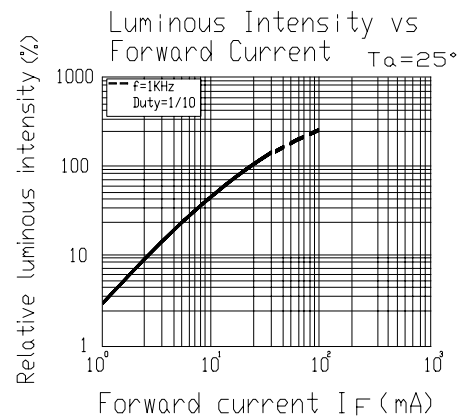
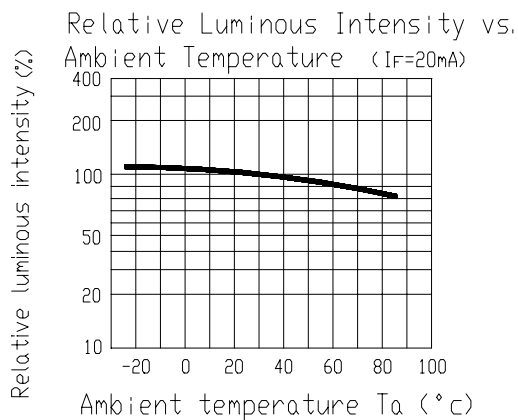
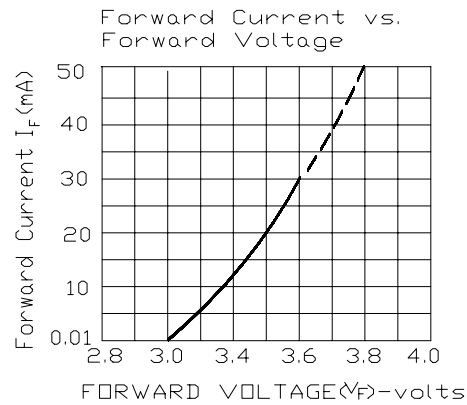
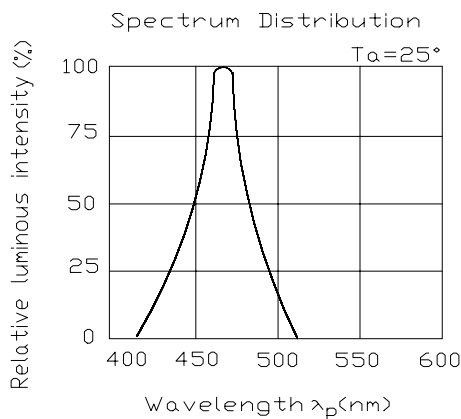



# EVERLIGHT ELECTRONICS CO.,LTD.

Device Number : DLE-731-008 REV: 1.0

5.2X3.8 mm Elliptical Wide Angle LEDs

PART NO : 7313-2UBD/C470/S1059 ECN :                      Page: 4/4

## ■ Reliability test items and conditions

NO	Item	Test Conditions	Test Hours/Cycle	Sample Size	Ac/Re
1	Solder Heat	TEMP : 260°C ± 5 °C	5 SEC	76 PCS	0/1
2	Temperature Cycle	H : +85°C 30min ┆ 5 min L : -55°C 30min	50 CYCLES	76 PCS	0/1
3	Thermal Shock	H : +100°C 5min ┆ 10 sec L : -10°C 5min	50 CYCLES	76 PCS	0/1
4	High Temperature Storage	TEMP : 100°C	1000 HRS	76 PCS	0/1
5	Low Temperature Storage	TEMP : -55°C	1000 HRS	76 PCS	0/1
6	DC Operating Life	TEMP : 25°C IF=20mA	1000 HRS	76 PCS	0/1
7	High Temperature / High Humidity	85°C/85% RH	1000 HRS	76 PCS	0/1