

ADAPTERS, BETWEEN SERIES

7mm / 3.5mm

DC - 18 GHz

PRECISION



MODELS: 5140, 5141

SPECIFICATIONS:

Electrical:

Frequency Range _____ DC - 18 GHz
VSWR _____ 1.08:1 Max.
Impedance _____ 50 Ohms
Operating Temp. Range _____ -65°C to +125°C

Mechanical:

3.5mm Connectors _____ Passivated Stainless Steel

Mates both Electrically and Mechanically with all
SMA & K* Series Connectors.

7mm Connectors _____ Electropolished Stainless Steel

IAW IEEE STD 287

Conductors _____ Gold Plated Beryllium Copper

K* is a Trademark of Wiltron Corp.

Model Number: 5140
7mm / 3.5mm Male

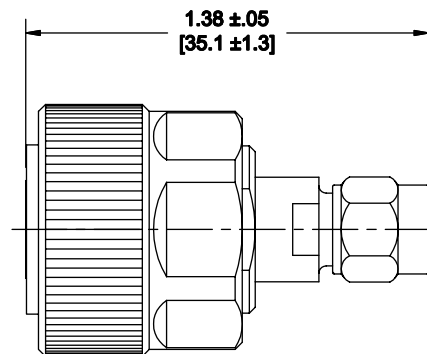

Model Number: 5141
7mm / 3.5mm Female

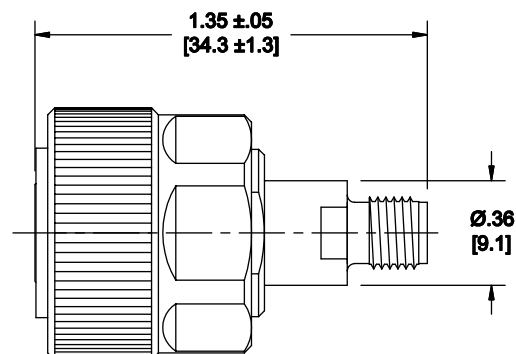

Note: Dimensions in Brackets are Expressed in Millimeters and are for Reference Only.

5140; REV C