

ADAPTERS, BETWEEN SERIES

TYPE N / SMA

DC - 18 GHz
ECONOMY



MODELS: 5056, 5057, 5058, 5059

SPECIFICATIONS:

Electrical:

Frequency Range _____ DC - 18 GHz
VSWR _____ 1.25:1 Max.
Impedance _____ 50 Ohms
Operating Temp. Range _____ -65°C to +125°C

Mechanical:

Connectors _____ Passivated Stainless Steel
Mates with MIL-STD-348
Conductors _____ Gold Plated Beryllium Copper

Model Number: **5056**
Type N Male / SMA Male

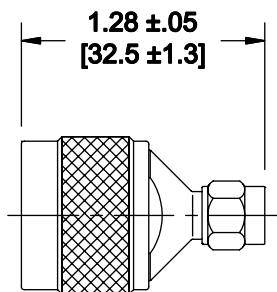

Model Number: **5059**
Type N Male / SMA Female

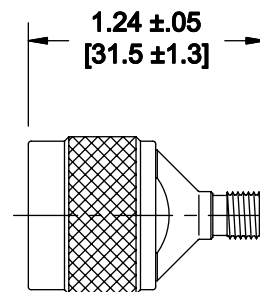

Model Number: **5057**
Type N Female / SMA Male

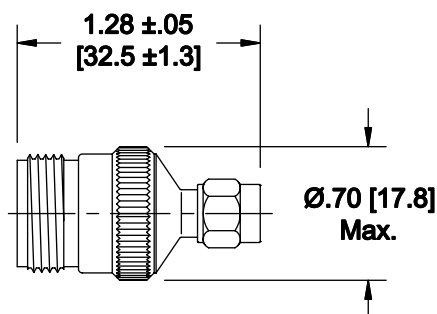

Model Number: **5058**
Type N Female / SMA Female

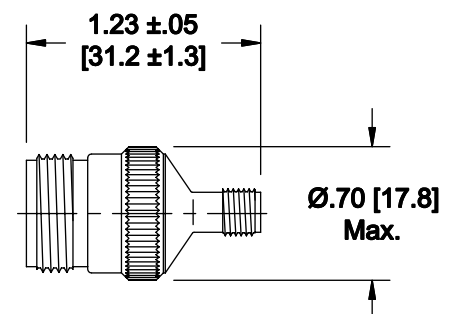

Note: Dimensions in Brackets are Expressed in Millimeters and are for Reference Only.
Units with gold plated connectors and/or optimized for RF leakage are also available.

5056; REV B