

ADAPTERS, IN-SERIES

BNC

DC - 8 GHz



MODELS: 5031, 5032 & 5033

SPECIFICATIONS:

Electrical:

Frequency Range _____ DC - 8.0 GHz
VSWR _____ 1.25:1 Max.
Impedance _____ 50 Ohms
Operating Temp Range _____ -65°C to +125°C

Mechanical:

Connectors _____ Nickel Plated Brass
(Mates with MIL-STD-348)

Conductors _____ Gold Plated Beryllium Copper

Model Number: 5031
Male/Female Connectors

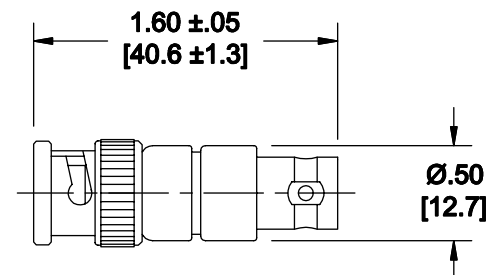

Model Number: 5033
Male/Male Connectors

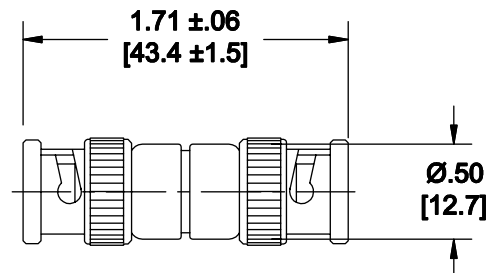

Model Number: 5032
Female/Female Connectors

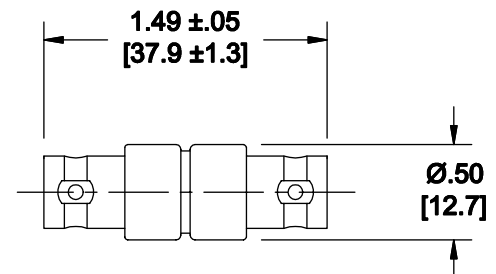

Note: Dimensions in Brackets are Expressed in Millimeters and are for Reference Only.
Selected units featuring very low return loss (VSWR) and units constructed for 75 Ohm impedance are also available.

5031; REV B