

# ADAPTERS, IN-SERIES

## SMA

DC - 18 GHz



MODELS: 5010, 5020, 5030, 5043, 5044 & 5045

### SPECIFICATIONS:

#### Electrical:

Frequency Range \_\_\_\_\_ DC - 18.0 GHz

VSWR

DC - 4 GHz \_\_\_\_\_ 1.05:1 Max.

4 - 8 GHz \_\_\_\_\_ 1.10:1 Max.

8 - 18 GHz \_\_\_\_\_ 1.15:1 Max.

Impedance \_\_\_\_\_ 50 Ohms

Operating Temp Range \_\_\_\_\_ -65°C to +125°C

#### Mechanical:

Connectors \_\_\_\_\_ See Below

(Mates with MIL-STD-348)

Conductors \_\_\_\_\_ Gold Plated Beryllium Copper

Model Number: **5030**

Male/Female Connectors  
Passivated Stainless Steel

Model Number: **5045**

Male/Female Connectors  
Gold Plated Stainless Steel

Model Number: **5020**

Male/Male Connectors  
Passivated Stainless Steel

Model Number: **5044**

Male/Male Connectors  
Gold Plated Stainless Steel

Model Number: **5010**

Female/Female Connectors  
Passivated Stainless Steel

Model Number: **5043**

Female/Female Connectors  
Gold Plated Stainless Steel

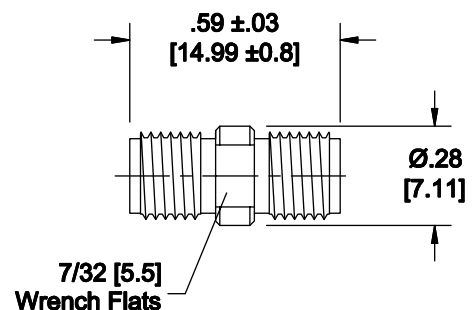
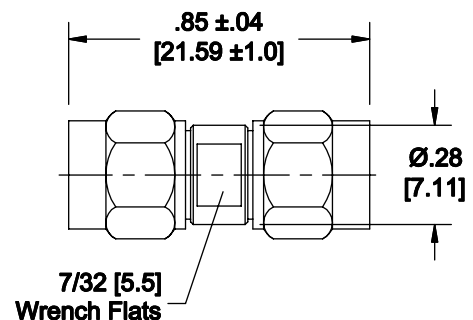
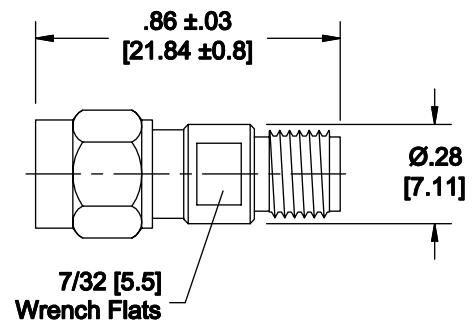

Note: Dimensions in Brackets are Expressed in Millimeters and are for Reference Only.  
Selected units featuring very low return loss (VSWR) and/or optimized RF leakage are also available.

5030; REV F