



EVERLIGHT ELECTRONICS CO.,LTD.

Device Number : DLE-425-014 REV: 1.0

3mm Round Small Flange Without stand-off LEDs, T-1

PART NO. : 4254SYGC/S996 ECN : Page: 1/4

■ Features :

- High luminous power.
- Can be driven at low current.
- 2.54mm lead spacing.
- Available on tape and reel.

■ Descriptions:

- The series is specially designed for applications requiring higher brightness.
- The LED lamps are available with different colors,intensities, epoxy colors, etc.

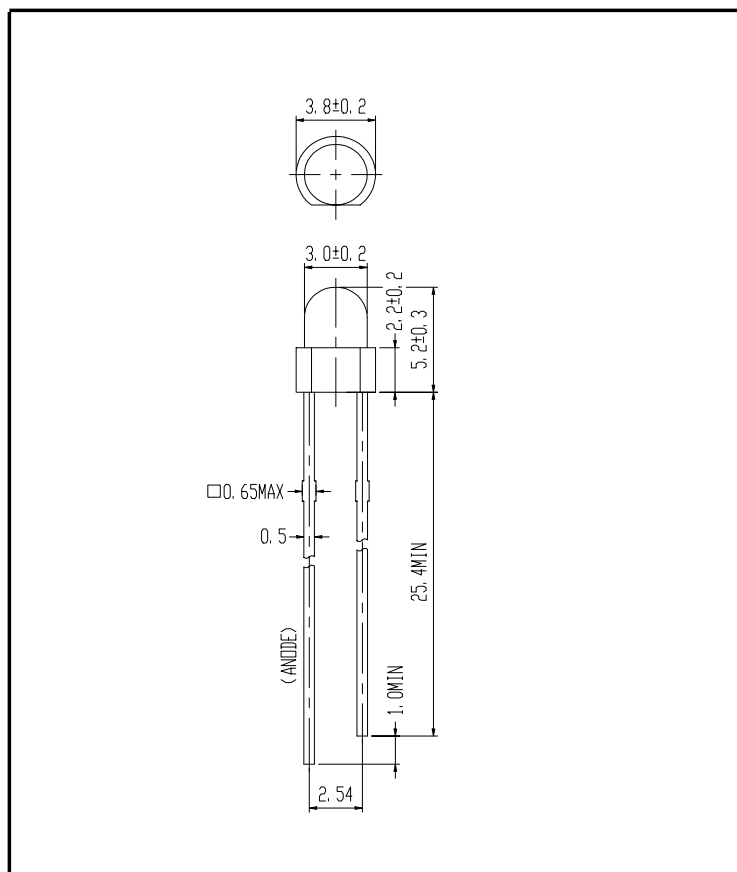

■ Applications :

- TV Set
- Monitor
- Telephone
- Computer

■ Notes :

- 1.All dimensions are in millimeters.
- 2.An epoxy meniscus may extend about 1.5mm(0.059")mm down to the lead.
- 3.Tolerances unless dimension ± 0.25 mm

PART NO.	Chip		Lens Color
	Material	Emitted Color	
4254SYGC/S996	AlGaInP	Super Yellow Green	Water Clear

B89092428.8910003

OFFICE : NO. 25,Lane 76,Sec.3, Chung Yang Rd., Tucheng 236, Taipei, Taiwan, R.O.C.

TEL : 886-2-2267-2000,2267-9936

FAX : 886-2-2267-6244,22676189,22676306

<http://www.everlight.com>



EVERLIGHT ELECTRONICS CO.,LTD.

Device Number : DLE-425-014 REV: 1.0

3mm Round Small Flange Without stand-off LEDs, T-1

PART NO. : 4254SYGC/S996 ECN : Page: 2/4

■ Absolute Maximum Ratings at Ta = 25°C

Parameter	Symbol	Rating	Unit
Forward Current	I _F	25	mA
Operating Temperature	T _{opr}	-40 to +85	°C
Storage Temperature	T _{stg}	-40 to +100	°C
Soldering Temperature	T _{sol}	260 ± 5	°C
Electrostatic Discharge	ESD	2000	V
Power Dissipation	P _d	60	mW
Peak Forward Current(Duty 1/10 @ 1KHz)	I _F	160	mA
Reverse Voltage	V _R	5	V

■ Electronic Optical Characteristics :

Parameter	Symbol	Min.	Typ.	Max.	Unit	Condition
Luminous Intensity	I _v	40	63	----	mcd	I _F =20mA
Viewing Angle	2 θ 1/2	-----	80	----	deg	I _F =20mA
Peak Wavelength	λ _p	----	575	----	nm	I _F =20mA
Dominant Wavelength	λ _d	----	573	----	nm	I _F =20mA
Spectrum Radiation Bandwidth	△ λ	----	20	----	nm	I _F =20mA
Forward Voltage	V _F	----	2.0	2.4	V	I _F =20mA
Reverse Current	I _R	----	----	10	μ A	V _R =5V



EVERLIGHT ELECTRONICS CO.,LTD.

Device Number : DLE-425-014

REV: 1.0

3mm Round Small Flange Without stand-off LEDs, T-1

PART NO. : 4254SYGC/S996

ECN :

Page: 3/4

Typical Electro-Optical Characteristic Curves

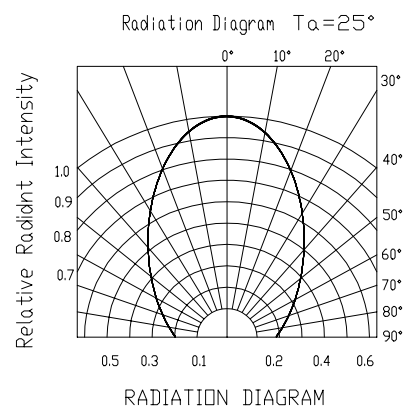
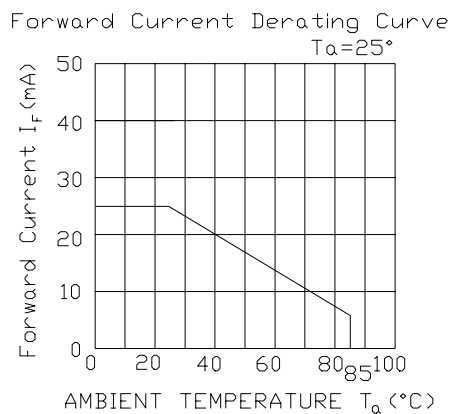
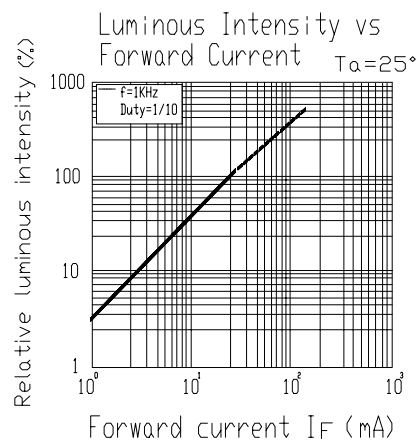
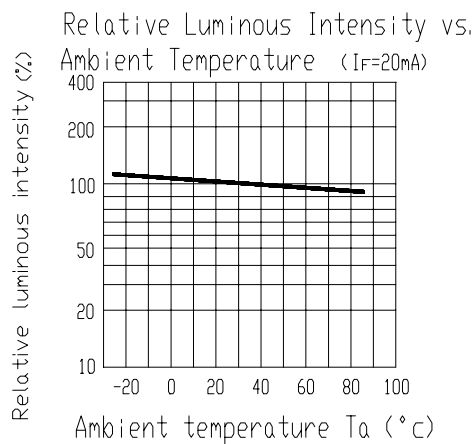
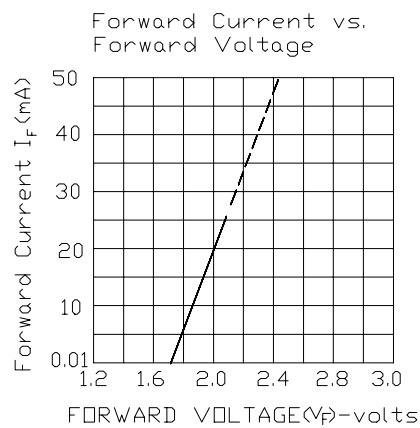
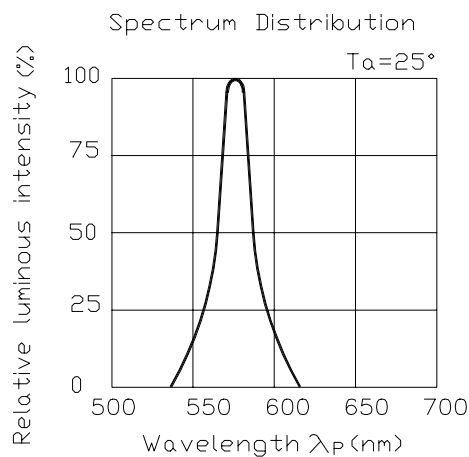



EVERLIGHT ELECTRONICS CO.,LTD.

Device Number : DLE-425-014 REV: 1.0

3mm Round Small Flange Without stand-off LEDs, T-1

PART NO. : 4254SYGC/S996 ECN : Page: 4/4

■ Reliability test items and conditions

NO	Item	Test Conditions	Test Hours/Cycle	Sample Size	Ac/Re
1	Solder Heat	TEMP : 260°C ± 5 °C	5 SEC	76 PCS	0/1
2	Temperature Cycle	H : +85°C 30min └ 5 min L : -55°C 30min	50 CYCLES	76 PCS	0/1
3	Thermal Shock	H : +100°C 5min └ 10 sec L : -10°C 5min	50 CYCLES	76 PCS	0/1
4	High Temperature Storage	TEMP : 100°C	1000 HRS	76 PCS	0/1
5	Low Temperature Storage	TEMP : -55°C	1000 HRS	76 PCS	0/1
6	DC Operating Life	TEMP : 25°C If=20mA	1000 HRS	76 PCS	0/1
7	High Temperature / High Humidity	85°C/85% RH	1000 HRS	76 PCS	0/1